

ITEM NO.	PART NUMBER	DESCRIPTION	QTY.	REVISION
1	CBC165JE002	CYLINDER	1	1
2	PRC165He002	PISTON	1	2 3983
3	SFC095VB003	GUIDE TUBE	1	3
4	SRC140WQ006	STOP RING	1	4
5	SSC165CA001	SEAL RETAINER	1	5
6	SRC082PL001	RETAINER	1	6
7	HA1003	SADDLE	1	7
8	STC095CA001	CIRCLIP	1	8
9	STC130BA001	CIRCLIP	1	9
10	CF1	COUPLER	2	10
11	PPC1	DUST COVER	2	11
12	VRA700AF002	RELIEF VALVE	1	12
13	BS4278-M12	EYEBOLT	2	13
14	X	PISTON SEAL	1	14
15	X	ROD SEAL	1	15
16	X	ROD SEAL	1	16
17	X	O - RING	1	17
18	X	BACK UP RING	1	18
19	X	O - RING	1	19
20	X	BACK UP RING	1	20
21	X	WIPER	1	
22	X	WIPER	1	
23	PTP213TH100	THREAD PROTECTOR	1	

ITEMS MARKED X ARE AVAILABLE IN SERVICE KIT HHR100TP1-K ONLY

IMPORTANT

WHEN ORDERING SPARES YOU MUST STATE THE FULL PART NUMBER AND THE PRODUCT SERIAL NUMBER - FROM THE LABEL TO PROTECT YOUR WARRANTY ALWAYS USE GENUINE HI-FORCE PARTS.

NOTES:

1. OBSOLETE PARTS REPLACE AS A PAIR WITH CBC165JE002 AND SRC140WQ006
2. EARLY MODELS FITTED WITH BEARING BSC165RF001

NOTE 2:

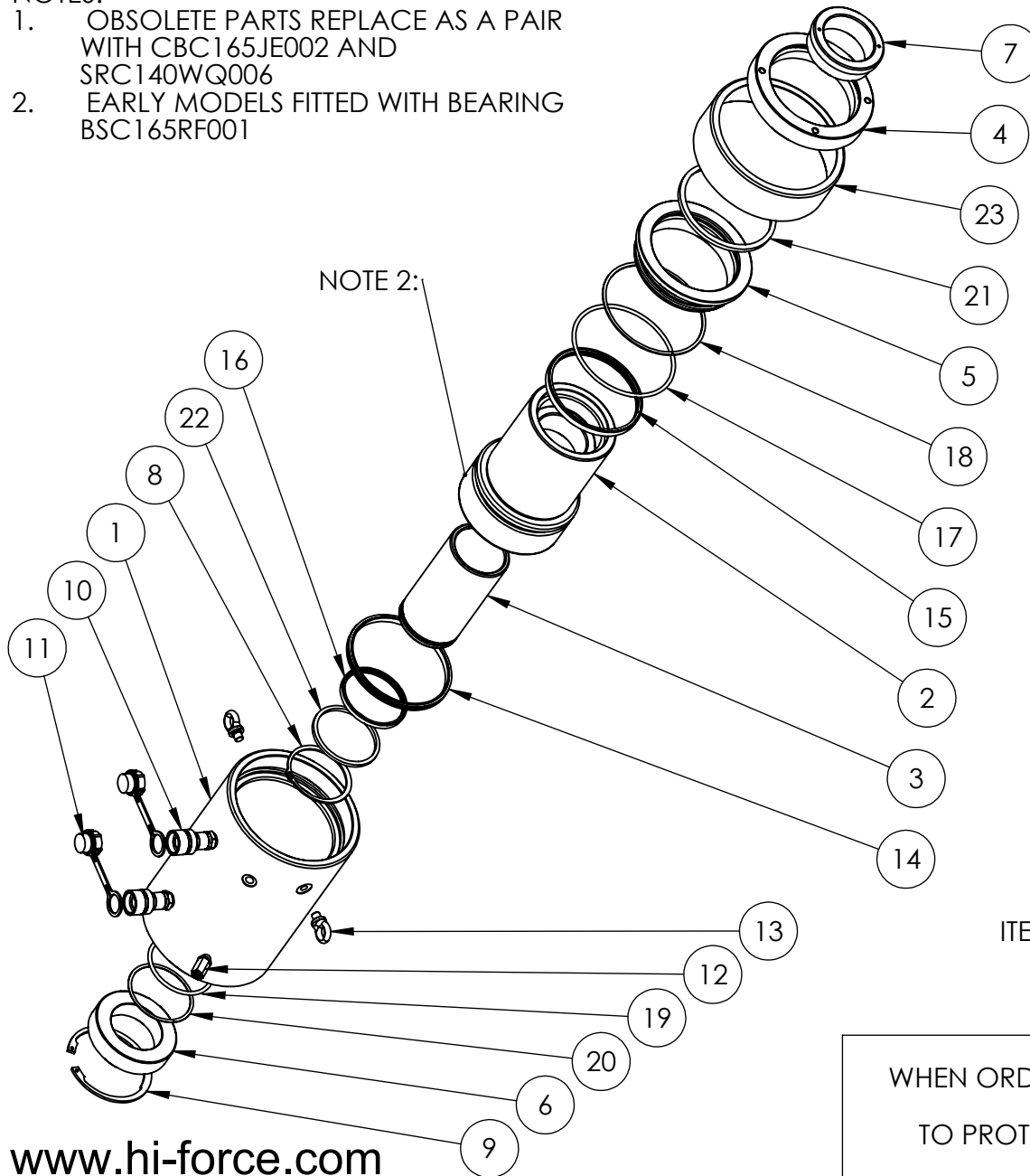

ITEM NO.	PART NUMBER	DESCRIPTION	QTY.	REVISION
1	CBC165JE001 (NOTE 1)	CYLINDER	1	1 3983
2	PRC165He002	PISTON	1	2
3	SFC095VB003	GUIDE TUBE	1	3
4	SRC140WQ001 (NOTE 1)	STOP RING	1	4
5	SSC165CA001	SEAL RETAINER	1	5
6	SRC082PL001	RETAINER	1	6
7	HA1003	SADDLE	1	7
8	STC095CA001	CIRCLIP	1	8
9	STC130BA001	CIRCLIP	1	9
10	CF1	COUPLER	2	10
11	PPC1	DUST COVER	2	11
12	VRA700AF002	RELIEF VALVE	1	12
13	BS4278-M12	EYEBOLT	2	13
14	X	PISTON SEAL	1	14
15	X	ROD SEAL	1	15
16	X	ROD SEAL	1	16
17	X	O - RING	1	17
18	X	BACK UP RING	1	18
19	X	O - RING	1	19
20	X	BACK UP RING	1	20
21	X	WIPER	1	
22	X	WIPER	1	
23	PTP213TH100	THREAD PROTECTOR	1	

ITEMS MARKED X ARE AVAILABLE IN SERVICE KIT HHR100TP1-K ONLY

IMPORTANT

WHEN ORDERING SPARES YOU MUST STATE THE FULL PART NUMBER AND THE PRODUCT SERIAL NUMBER - FROM THE LABEL TO PROTECT YOUR WARRANTY ALWAYS USE GENUINE HI-FORCE PARTS.