

REVISION

1	5479
2	5551
3	5784
4	6163
5	
6	
7	
8	
9	
10	
11	
12	
13	
14	
15	
16	
17	
18	
19	
20	

IMPORTANT

WHEN ORDERING SPARES YOU MUST STATE THE FULL PART NUMBER AND THE PRODUCT SERIAL NUMBER - FROM THE LABEL TO PROTECT YOUR WARRANTY ALWAYS USE GENUINE HI-FORCE PARTS.

ITEM NO.	PART NUMBER	DESCRIPTION	QTY.	SPARE PARTS	SERVICE PARTS
1	BLC005HD016	M5 x 15 HEX SOCKET CAP HEAD SCREW	2		
2	SEC080XE001	WIPER	1		✓
3	SRC080SJ001	STOP RING	1		
4	BSC095PC001	BEARING	2		
5	SPC043TP001	TENSION SPRING	1		
6	FFC004RC001	FILTER	1		
7	CBC095VN001	CYLINDER	1		
8	CF1	COUPLER	1		
9	PPC1	DUST COVER	1		
10	BLC008KD040	M8 x 40 SOCKET CAP HEAD SCREW	1		
11	BLC006JE012	M6 x 12 HEX SOCKET COUNTERSUNK SCREW	4		
12	SFC135HA001	BASE PLATE	1		
13	HLC065AL001	HANDLE	1		
14	BLC008KY016	STAINLESS STEEL M8 X 16 CAP HEAD SCREW	2		
15	SIC033TC001	SPRING INSERT	2		
16	SEC095PA001	STEP SEAL	1		✓
17	PRC095YN001	PISTON	1		
18	WAC008KD000	DOWTY WASHER	2		✓
19	BLC008KD060	M8 x 60 HEX SOCKET CAP HEAD SCREW	1		
20	BSC080PE001	BEARING	1		
21	HA50	SADDLE.	1		

REVISION

1	5479
2	5551
3	5784
4	6163
5	
6	
7	
8	
9	
10	
11	
12	
13	
14	
15	
16	
17	
18	
19	
20	

NOTES:

- ALL PARTS ARE AVAILABLE TO BE ORDERED AS SPARE PARTS (UNLESS MARKED WITH x).

- ONLY PARTS MARKED WITH ✓ ARE AVAILABLE AS BOTH SPARE PARTS OR SERVICEABLE PARTS, FROM HAS50TP1-K SERVICE KIT. (REFER TO HAS50TP1-K EVD FOR FULL PARTS LIST)

IMPORTANT

WHEN ORDERING SPARES YOU MUST STATE THE FULL PART NUMBER AND THE PRODUCT SERIAL NUMBER - FROM THE LABEL TO PROTECT YOUR WARRANTY ALWAYS USE GENUINE HI-FORCE PARTS.

REVISION

1	6163
2	
3	
4	
5	
6	
7	
8	
9	
10	
11	
12	
13	
14	
15	
16	
17	
18	
19	
20	

ITEM NO.	PART NUMBER	DESCRIPTION	QTY.
1	SEC080XE001	WIPER	1
2	SEC095PA001	STEP SEAL	1
3	WAC008KD000	DOWTY WASHER	2

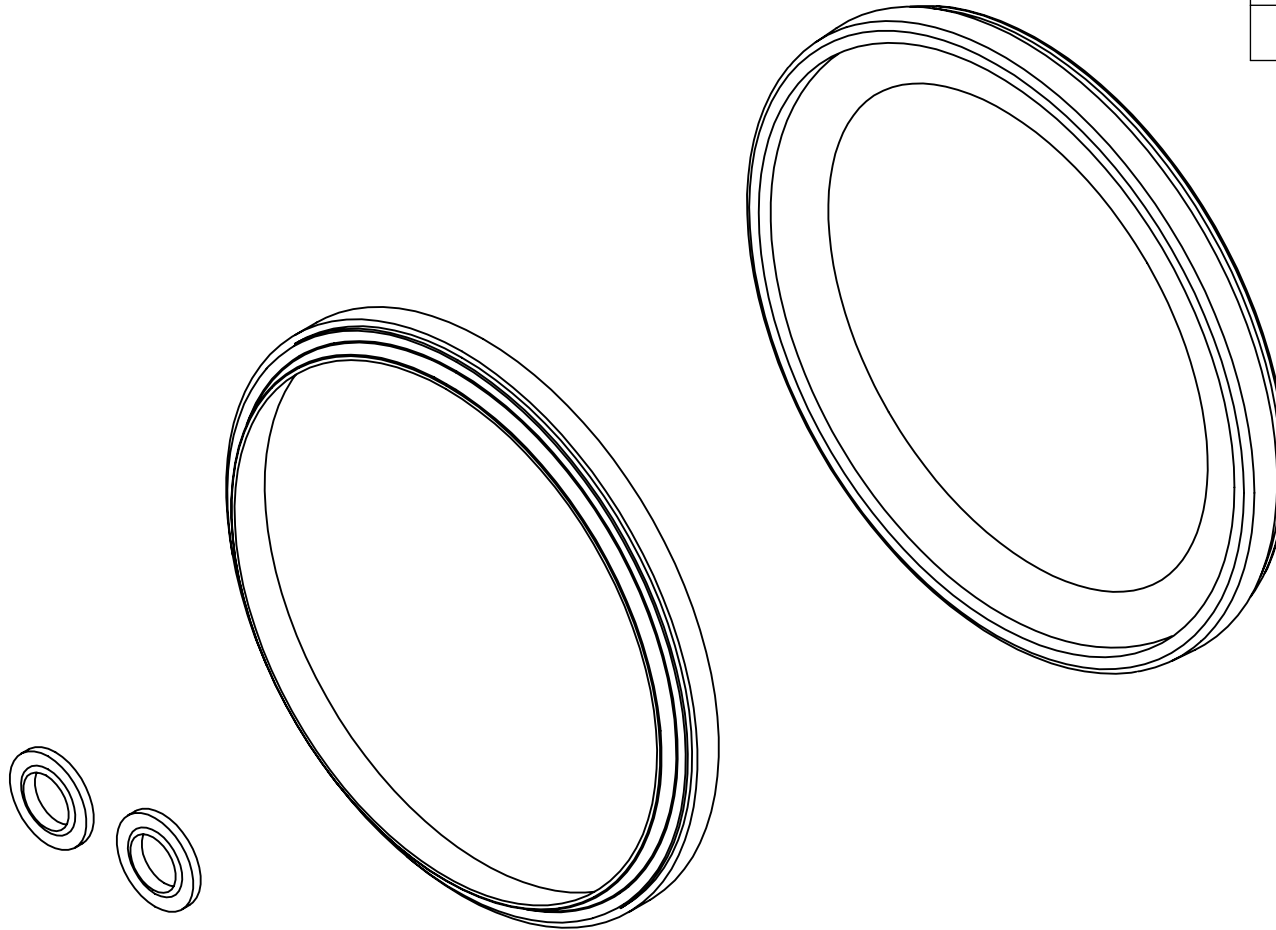

IMPORTANT
WHEN ORDERING SPARES YOU MUST STATE THE FULL PART NUMBER AND THE
PRODUCT SERIAL NUMBER - FROM THE LABEL
TO PROTECT YOUR WARRANTY ALWAYS USE GENUINE HI-FORCE PARTS.